

Brake Rotor Set-Up Sheet, Solid Mount

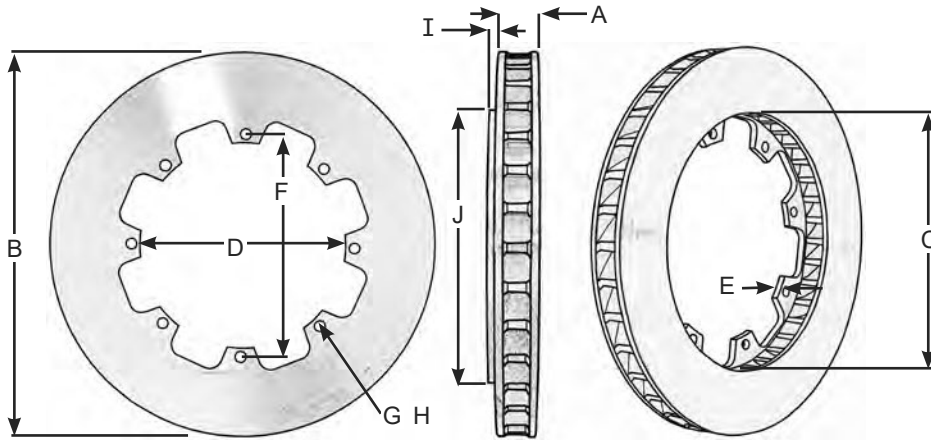

NO METRIC SIZES DO NOT SEND SAMPLE ROTORS WITH HATS ATTACHED

Options

- Casting: Lightweight
Standard Duty
Heavy Duty
- Vane Type: Straight
Curved
- Stress Relieving: Yes / No
- Gas Venting: Yes / No
- Cross Drilling: Yes / No
- Balancing: Yes / No

- "A" (Thickness) _____
- "B" (Diameter) _____
- "C" (Eye Diameter) _____
- "D" (Flange Diameter) _____
- "E" (Flange Thickness) _____
- "F" (Bolt Circle) _____
- "G" (No. Of Holes) _____
- "H" (Hole Size) _____

- "I" Step Out (Height) _____
- "J" Step In (Depth) _____
- "J" Step Diameter _____

NOTE: All Tolerances Are +/- .005 Unless Otherwise Specified By The Customer.

Approved By: _____

Date: _____

All custom rotors require filling out our custom rotor set-up sheet, a sample or blueprint. We cannot build any custom rotors with dimensions supplied over the phone. Coleman Machine, Inc. is not responsible for any failure of custom rotors due to improper fit, tolerances or issues encountered with the sizes or design of the finished part machined to customers specifications.

Brake Rotor Set-Up Sheet, Floating Mount (Bobbin Style)

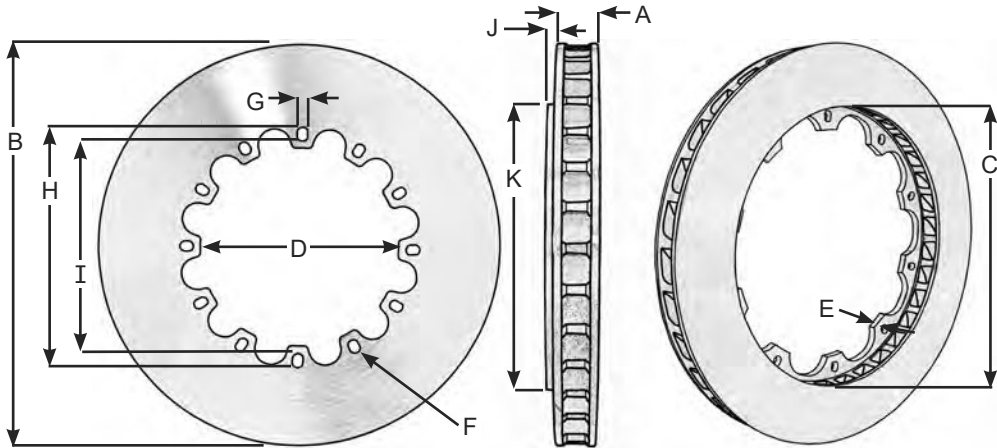

NO METRIC SIZES DO NOT SEND SAMPLE ROTORS WITH HATS ATTACHED

Options

- Casting: Lightweight
Standard Duty
Heavy Duty
- Vane Type: Straight
Curved
- Stress Relieving: Yes / No
- Gas Venting: Yes / No
- Cross Drilling: Yes / No
- Balancing: Yes / No

- "A" (Thickness) _____
- "B" (Diameter) _____
- "C" (Eye Diameter) _____
- "D" (Flange Diameter) _____
- "E" (Flange Thickness) _____
- "F" (No. Of Slots) _____
- "G" (Slot Width) _____
- "H" (Slot Outside to Outside) _____
- "I" (Slot Inside to Inside) _____

- "J" Step Out (Height) _____
- "J" Step In (Depth) _____
- "K" Step Diameter _____

NOTE: All Tolerances Are +/- .005 Unless Otherwise Specified By The Customer.

Approved By: _____

Date: _____

All custom rotors require filling out our custom rotor set-up sheet, a sample or blueprint. We cannot build any custom rotors with dimensions supplied over the phone. Coleman Machine, Inc. is not responsible for any failure of custom rotors due to improper fit, tolerances or issues encountered with the sizes or design of the finished part machined to customers specifications.

Brake Rotor Set-Up Sheet, Floating Mount (Bobbin Style)

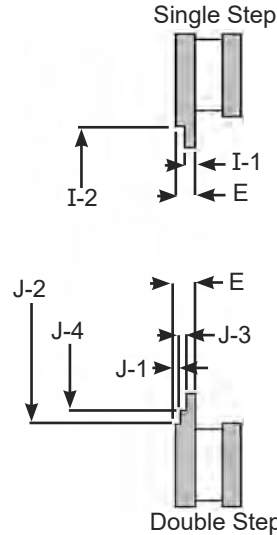
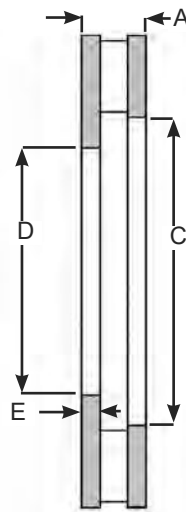
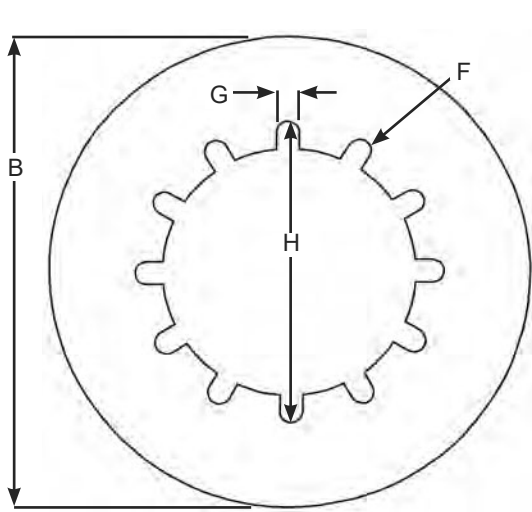

- Options**
- Casting: Lightweight
Standard Duty
Heavy Duty
 - Vane Type: Straight
Curved
 - Stress Relieving: Yes / No
 - Gas Venting: Yes / No
 - Cross Drilling: Yes / No
 - Balancing: Yes / No

NO METRIC SIZES DO NOT SEND SAMPLE ROTORS WITH HATS ATTACHED

- "A" (Thickness) _____
- "B" (Diameter) _____
- "C" (Eye Diameter) _____
- "D" (Flange Diameter) _____
- "E" (Flange Thickness) _____
- "F" (No. Of Slots) _____
- "G" (Slot Width) _____
- "H" (Slot Tip to Tip) _____
- "I-1" (Step In Depth) _____
- "I-2" (Step Diameter) _____

- "J-1" (1st Step Depth) _____
- "J-2" (1st Step Diameter) _____
- "J-3" (2nd Step Depth) _____
- "J-4" (2nd Step Diameter) _____

NOTE: All Tolerances Are +/- .005 Unless Otherwise Specified By The Customer.

Approved By: _____

Date: _____

All custom rotors require filling out our custom rotor set-up sheet, a sample or blueprint. We cannot build any custom rotors with dimensions supplied over the phone. Coleman Machine, Inc. is not responsible for any failure of custom rotors due to improper fit, tolerances or issues encountered with the sizes or design of the finished part machined to customers specifications.